

The next level of sliding doors



APL's innovative ThermalHEART[®] technology has significantly improved the performance of sliding doors, across Metro Series ThermalHeart+[®] and APL Architectural Series ThermalHeart+[®].

Performance highlights

- Fully pressure equalised open sill design with no drainage restriction. Risk is minimised as the sill profile is unable to hold volumes of water
- Air seals within the door framing system are in positions water is unable to reach
- No specific applications of sealant or components are required to achieve performance levels; the pressure and water management in the door system allows simple details to exceed performance requirements
- A unique panel guidance system eliminates all air and water transfer paths common in traditional door designs, particularly useful on multi panel units
- Tested to EM7 category to enable automatic compliance option in mid rise buildings up to 25m.

Installation

- The door system features multiple fixing point options
- A Centrafix[®] option is available
- Architectural multi perimeter options version is available (Sill trays, Seismic frames, applied external facings and internal finishing trims)
- A poorly handled or installed door will not have compromised weather performance within the unit as no critical sealing details are required.

Useability

The sill profile design and panel guidance features reduce seal friction for easy user operation whilst achieving a Class 4 Air permeability rating.

Patented

The innovative Sill Safe drainage system is protected by NZ Pat App No. 509183.

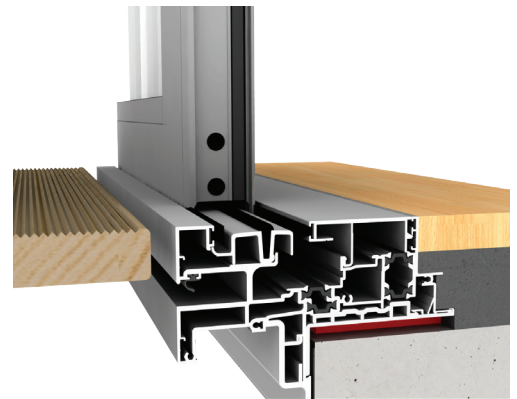

Sliding door sill - single panel
Centrafix[®] frame shown

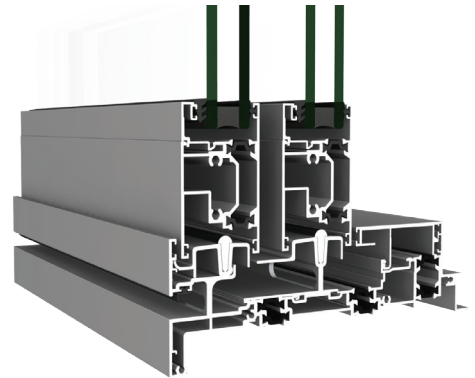

Multi slider sill frame

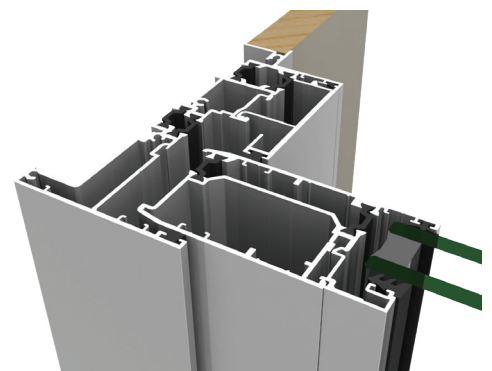

Sliding door jamb detail